

## Typical detail:

### New roof with board insulation

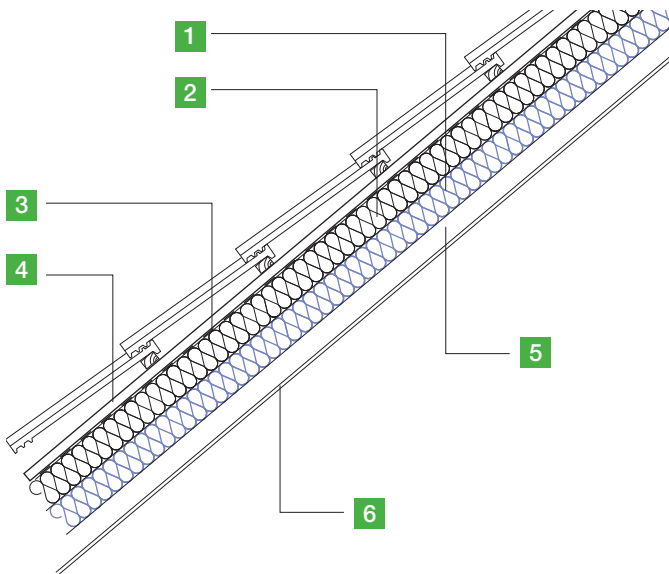

1. WALLTITE CL100 insulation between rafters to achieve target U-value
2. Over rafter PIR board insulation (minimum 50mm thick)
3. Breathable roof tile underlay
4. Counter-batten
5. Unventilated air space
6. Plasterboard and skim

Habitable space: plasterboard and skim/VCL with taped joints VCL to be carefully cut and sealed around struts, ceiling joists and penetrations); batten/counter batten rafters as necessary to achieve insulation depth, confirm rafter strength sufficient to receive counter battening and boarding if required.

Loft space only, non habitable: insulated between and over rafters to achieve target U-value. WALLTITE may remain exposed.